

**Lamello**

# Cabineo



Time-saving furniture connector  
without edge drilling and with  
very high clamping force



**NEW**



## Cabineo – simple, fast, strong

- Efficient machining with all CNC machines
- Faster processing times
- Fewer process steps
- Lower transport volume
- Shorter assembly times
- Stronger connections

*"The Cabineo saves time – machining and assembly takes seconds, which significantly impacts the production chain."*

*Mr Christoph Büchi, director, carpentry Büchi Ag in Liestal, Switzerland*





# Advantages of Cabineo

## 1. Time-saving in production



- Optimised process due to surface machining; no edge drilling necessary
- Only one tool change from 5 mm to 15 mm drill; no tool change for the dowel hole drill necessary
- No dowel holes means less drill holes per connector
- Shallow element of 10mm allows for panels from 12mm thickness



No edge drilling



No dowel holes

## 2. Time-saving in transportation



- Efficient pre-installation of the one-piece connector in the factory
- Flat-Pack delivery with pre-installed connectors
- No extra bags or loose hardware required with furniture shipment
- Detachable for transport or if the fixed shelves need adjusting



One-piece and preinstalled

## 3. Time-saving in the assembly



- One-piece connector without dowels; no pre-assembly of screws or dowels in the side panels necessary
- Easy positioning of the Cabineo in the corresponding hole due to the protruding screw
- Fast assembly with a cordless drill
- Installation of fixed shelves or vertical dividers in an already assembled unit



Fast Assembly



Installation of fixed shelves in assembled units

# Comparison with cam and dowel

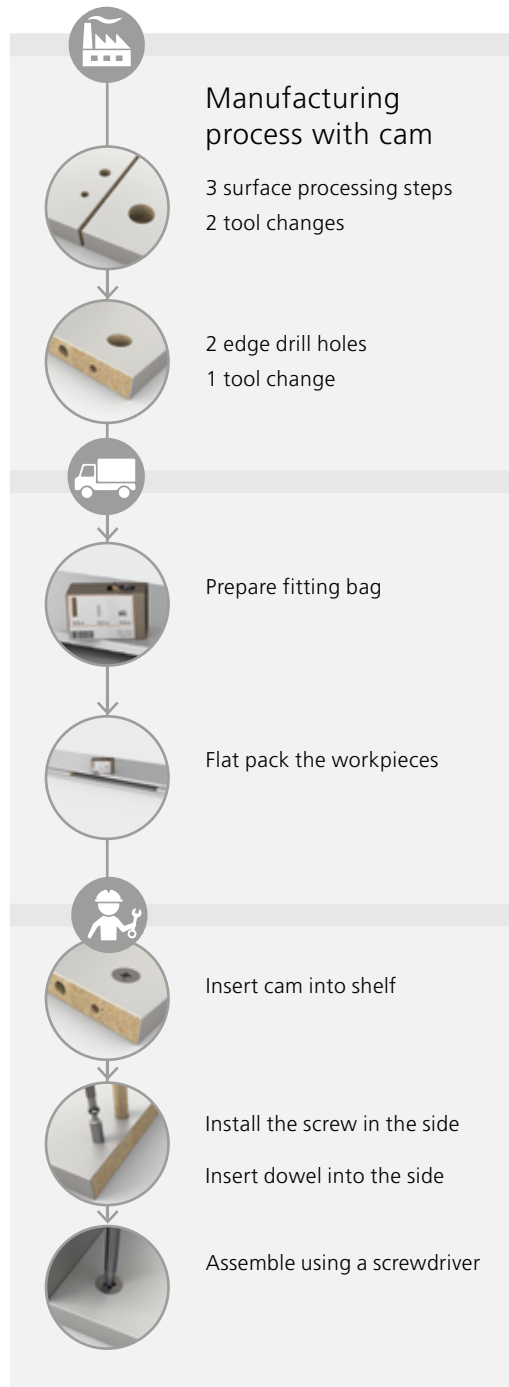
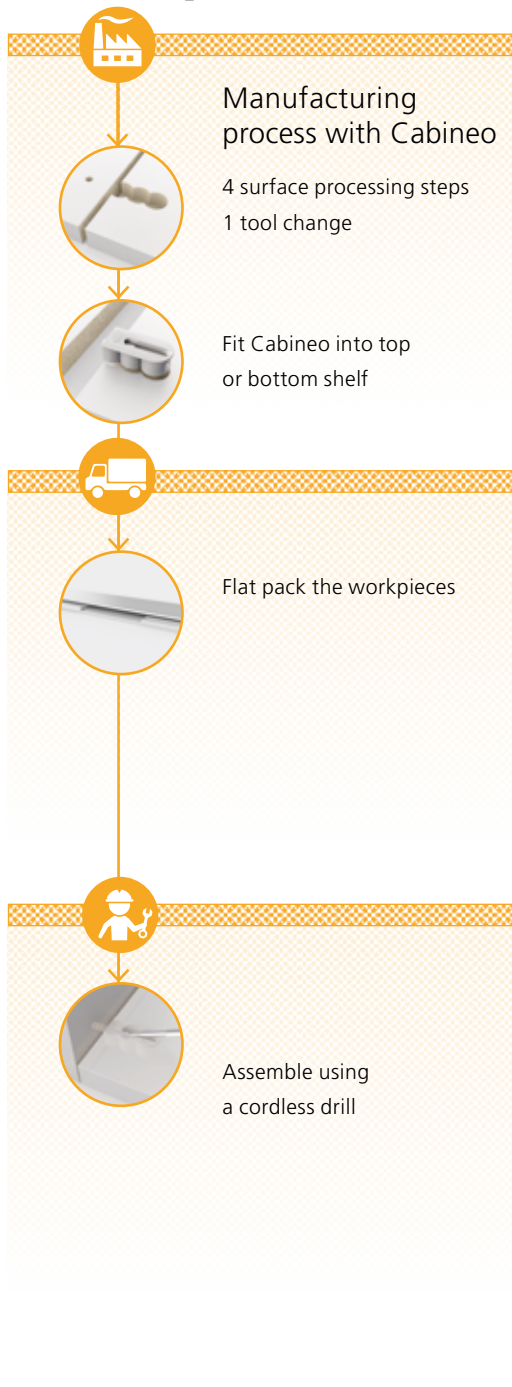

# Three installation options

1. On the surface

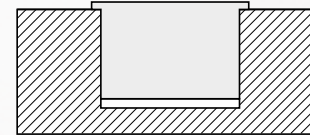

2. Flush with the surface

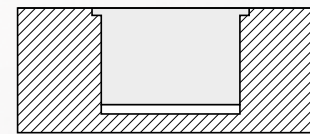

3. Flush cover cap

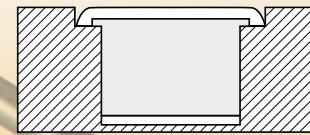

- **Easy cleaning**  
of cabinet interior –  
no protruding connectors
- **Effortless insertion**  
of files or folders
- **Perfect appearance**  
thanks to large range of  
cover cap colors

*Tipps & Tricks*  
Are you looking for  
joining elements for your  
furniture that are flush  
with the surface? Read  
the latest tips and tricks  
on [www.lamello.com](http://www.lamello.com).





# Machining with all CNC machines

The Cabineo can be drilled or machined

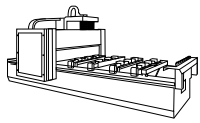

CNC processing centres  
with **consoles**

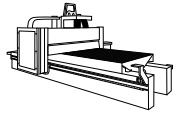

CNC processing centres  
with nesting **technology**

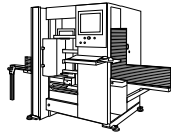

**Vertical CNC**  
processing centres

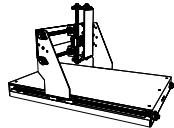

CNC **router**

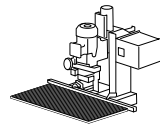

**Drilling and insertion**  
machines

## Machining: **Side panel**

Drill Ø 5 mm  
(HPL -> Ø 5.5 mm)

Cabineo 8: X = 8 mm  
(Black screw)

Cabineo 12: X = 12 mm  
(Nickel plated screw)

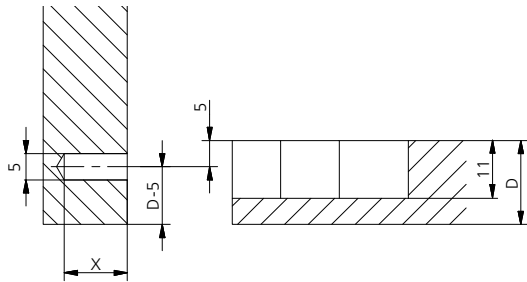

## Machining: **Bottom, top or fixed shelf**

Option 1:  
Drill Ø 15 mm

Option 2:  
Cutter Ø 10 mm or smaller

Option 3:  
Cutter Ø 12 mm

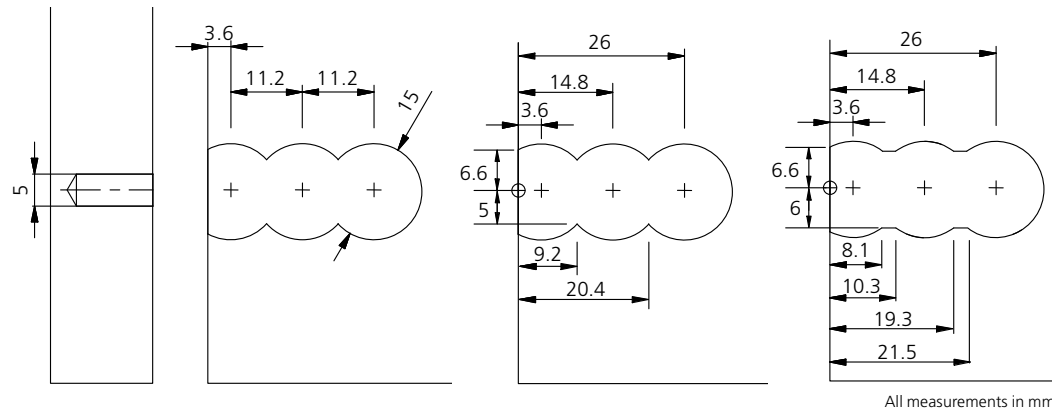

All measurements in mm

# Clever assembly



Flatpack workpiece delivery with pre-assembled  
connector



Place furniture side on base. The element is  
correctly positioned by the protruding screw



Join furniture elements with cordless screwdriver  
and Cabineo tool. Easy, fast working with preset  
torque about 2.5 Nm



Position top and push towards the  
furniture side

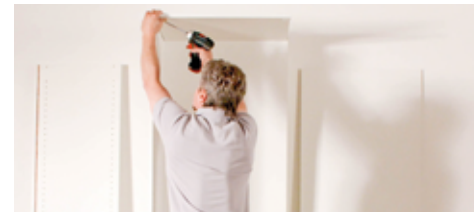

Screw front corner in place with a cordless  
screwdriver. This makes one-man assembly easy

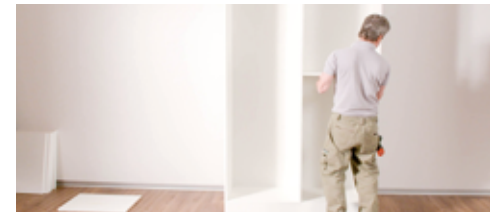

After assembly, fasten the fixed intermediate  
shelves in the required positions

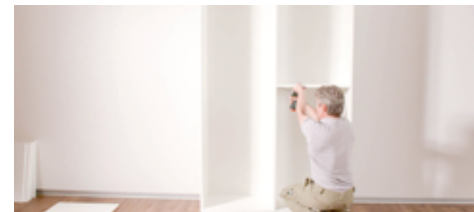

Tip: - Place one side of the shelf on the shelf  
support and fasten the other side  
- Retract the screw to facilitate  
installation



If required, use cover caps on the Cabineo

# Shop fitting

✓ High stability

✓ Shelves can be pushed in and secured after installation



# Kitchen fitting

✓ Can be shipped as flat-pack

✓ Pre-mounted screws mean quick assembly



When used in dark materials, the Cabineo black fuses with the background, so that no additional cover caps are necessary.

# Furniture with thin materials

✓ from 12mm, also available in HPL material

✓ Cover caps in various colours for improved aesthetics



# Cabineo articles

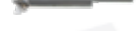

## Cabineo articles

## Part no.

Cabineo Starter Set, Cabineo 8 + 12, 40 pcs each,	
Cabineo tool with handle, cover caps (40 pcs) .....	<b>186305</b>
Cabineo 8, for dividing panels from 16 mm, 500 pcs .....	<b>186310</b>
Cabineo 8, for dividing panels from 16 mm, 2000 pcs .....	<b>186311</b>
Cabineo 12, 500 pcs .....	<b>186320</b>
Cabineo 12, 2000 pcs .....	<b>186321</b>
Cabineo 8 black, for dividing panels from 16mm, 500 pcs .....	<b>186340</b>
Cabineo 8 black, for dividing panels from 16mm, 2000 pcs .....	<b>186341</b>
Cabineo 12 black, 500 pcs .....	<b>186330</b>
Cabineo 12 black, 2000 pcs .....	<b>186331</b>
Cabineo tool with handle .....	<b>256300</b>
Cabineo hex bit .....	<b>276312</b>
Cabineo hex bit 1/4" GL 80 mm .....	<b>276306</b>
Cabineo hex bit 1/4" GL 80 mm, 100 pieces .....	<b>276307</b>
Cabineo drill Ø 15 mm with short centering point 0.8 mm .....	<b>136312</b>
Cabineo cutter Ø 10 mm .....	<b>136310</b>
Cabineo cutter Ø 12 mm .....	<b>136311</b>
Cabineo drills for aggregate, set with 3pcs Ø1 mm (RL/LL/RL) carbide tipp	<b>136313</b>

## Cabineo cover caps

## Part no.

## Part no.

		100 pcs	2000 pcs
Signal white .....	RAL 9003 .....	<b>186350S</b> .....	<b>186351S</b>
Pure white .....	RAL 9010 .....	<b>186350W</b> .....	<b>186351W</b>
Papyrus white .....	RAL 9018 .....	<b>186350P</b> .....	<b>186351P</b>
Light ivory .....	RAL 1015 .....	<b>186350H</b> .....	<b>186351H</b>
Brown beige .....	RAL 1011 .....	<b>186350B</b> .....	<b>186351B</b>
Fawn brown .....	RAL 8007 .....	<b>186350R</b> .....	<b>186351R</b>
Mouse grey .....	RAL 7005 .....	<b>186350F</b> .....	<b>186351F</b>
Window grey .....	RAL 7040 .....	<b>186350A</b> .....	<b>186351A</b>
Jet black .....	RAL 9005 .....	<b>186350T</b> .....	<b>186351T</b>
Metallic-look .....	silver .....	<b>186350C</b> .....	<b>186351C</b>
Metallic-look .....	nickel .....	<b>186350N</b> .....	<b>186351N</b>
Metallic-look .....	dark steel .....	<b>186350D</b> .....	<b>186351D</b>

**Lamello**

**Lamello AG**  
**Joining technology**  
 info@lamello.com  
 www.lamello.com