

Metal Retainer 2680

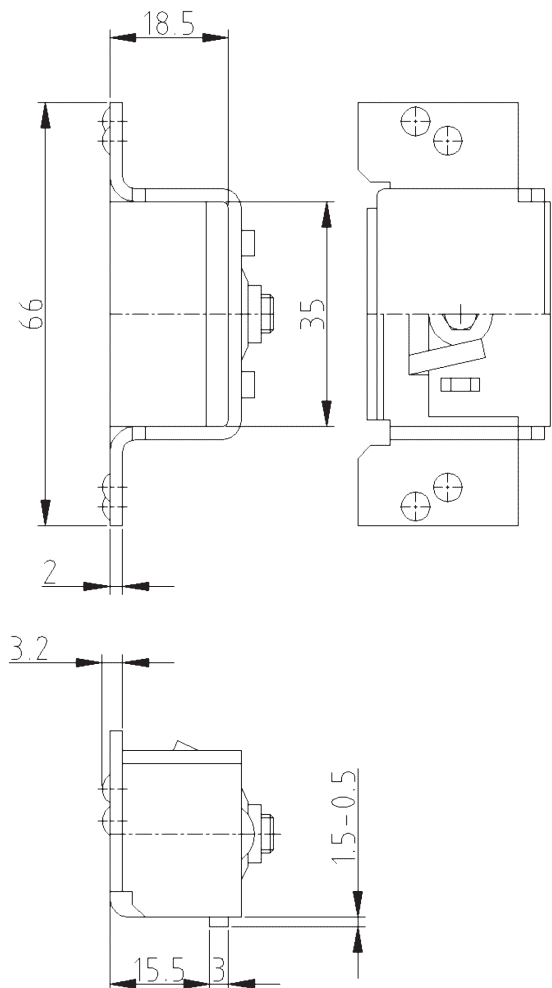

Additional Information

Standard load: Maximum door weight 50 kg (per pair)
 Application: Steel frames, retainer with plastic case
 Combination: Combi Hinges: Frame parts 1581, 2680, 2681 and 2682
 Heavy Duty Hinges: 2881 MF, 2881 MF CS, 2886 MF, 2044/2080/100, 2039/2080/100, 2049/2080/100 CS

Section drawing

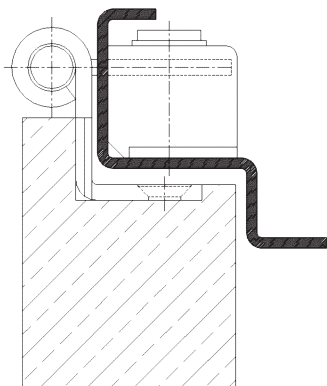

Item	Finish	Packing Unit
039081	zinc plated	100